

# AS4V34VE

**STANDARD MATERIALS AND CONSTRUCTION**

**FRAME:** .081" thick (nominal) extruded aluminum 6063-T52/T6 alloy.

**BLADE:** .081" thick (nominal) extruded aluminum 6063-T52/T6 alloy.  
Blades spaced approximately 3" on center with architectural hidden mullions.

**SUPPORTS:** Shall incorporate rear angle 2" x 2" x 1/4" extruded aluminum to withstand windload of 20 PSF, approximately 90 mph wind. Supports vary as required, per wind load. Spaced approximately 60" on centers.

**FINISH:** Mill

**OPTIONS**

Variations - Mitered Corner, Post Corner, Hinged Access, and Cap Covers.

Finishes - Kynar, Baked Enamel, Clear and Color Anodize (Consult the factory for details.)

**NOTES**

1. "Maximum panel size should not exceed 60 sq. ft. or 120"W x 72"H. Louver sections larger than the factory maximum size will require field assembly of smaller sections.
2. Approximate shipping weight is 4.5 lbs./sq.ft.

**LOUVER SIZES**

Min Panel	Max Single Panel
12"W x 12"H	120"W x 72"H (60 sq.ft.)

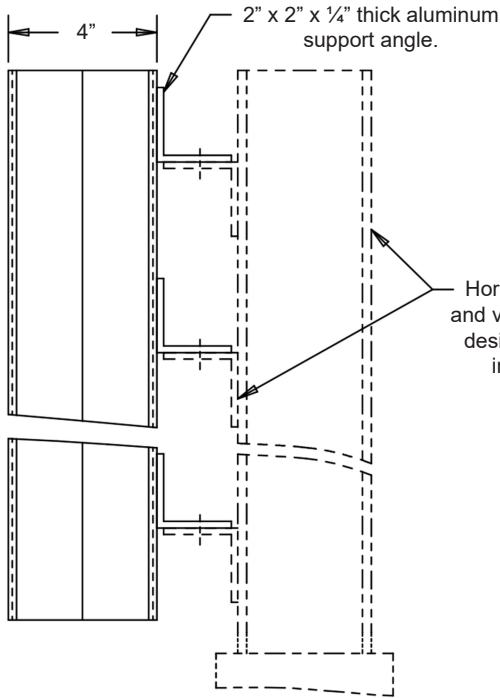

Not to scale

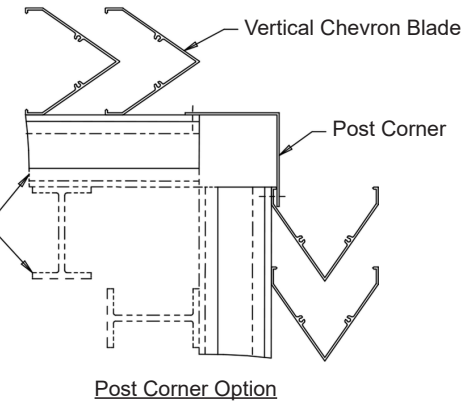
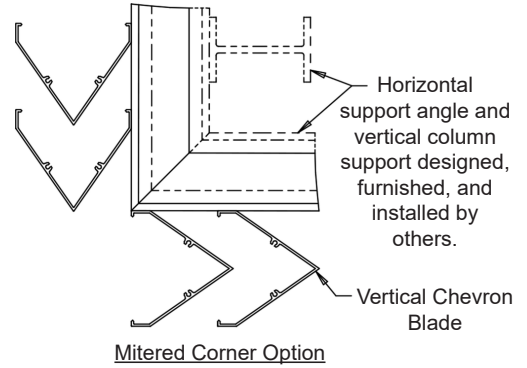

In the interest of product development, Airline Louvers reserves the right to make changes without notice.

Item #	Qty	Height	Width	Mullion	Mitered	Post	Union Made	
		Screen Size			Corner Type			
Arch. / Eng. :				EDR:	ECN:	Job:		
Contractor:								
Project:				Date:	DWN:	DWG:		